



# ATG Electronics® iBright™ E25i T5 LED Tube USER GUIDE

**Part Number** HFL-5030N-060601-L3  
 HFL-5060N-120601-L3  
 HFL-5081N-060601-L3



**NOTE:**

Please read this entire manual to fully understand and safely use this product.

Specifications are subject to change without notice. Please visit [www.atgelectronics.com](http://www.atgelectronics.com) for the most recent user guide versions.

**Included in this Box**

- ATG Electronics® iBright™ E25i T5 LED Tube, 1 PCs
- User Guide, 1 Set
- Accessory Kit, 1 Set, including
  - External Power Supply, 1 PCs
  - Wire Nuts, 5 PCs
  - Screws, 3 PCs

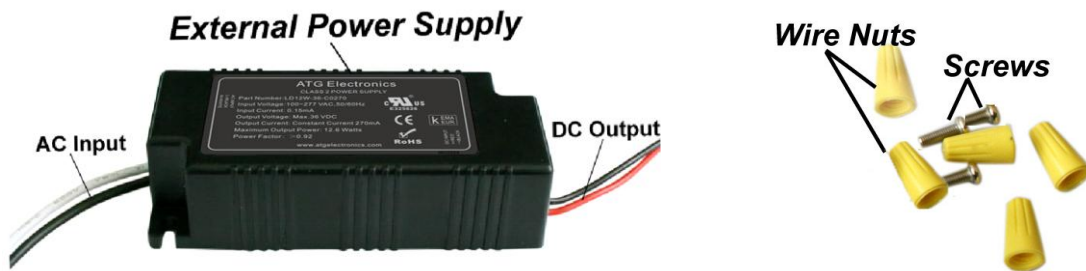

**PLANNING THE INSTALLATION**

iBright™ E25i can ONLY work with specific matching external power supply. Unmatched or other specification power supplies will make iBright™ E25i burn out. Shown below in table 1 are matching external power supplies compatible with iBright™ E25i.

**Table 1: iBright™ E25i VS. Matching External Power Supply**

iBright™ E25i	Matching External Power Supply
HFL-5030N-060601-L3 (30LEDs, 0.6m)	LD12W-36-C0270
HFL-5060N-120601-L3 (60LEDs, 1.2 m)	LD20W-36-C0550
HFL-5081N-060601-L3 (81LEDs, 1.5m)	LD25W-36-C0810

**Installation Steps**

iBright™ E25i works ONLY with specific matching external power supply, which can be found in the package.

For retrofit or new installation, existing ballast shall be replaced with the matching external power supply, existing starter shall be removed, and circuit shall be reconfigured.

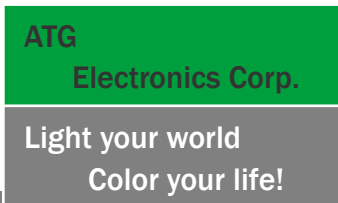

## ● Retrofit Luminaire with Electronic Ballast

Before

Figure 1

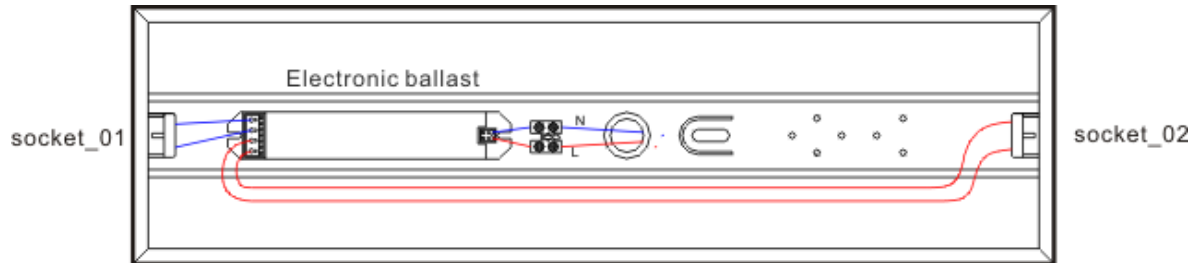

### Installation Steps

Step 1: Turn off main power before installation

For safety, make sure main power source is switched off before attempting to install.

Step 2: Take existing fluorescent light out.

Existing fluorescent light is not needed. You might recycle it as appropriate.

Step 3: Open the ballast cover and disconnect all power wires from ballast and take the ballast out of the fluorescent luminaire shown as Figure 2 below.

Keep one wire of each socket to connect with the external power supply. The other wire shall be cut off immediately near the socket.

Figure 2

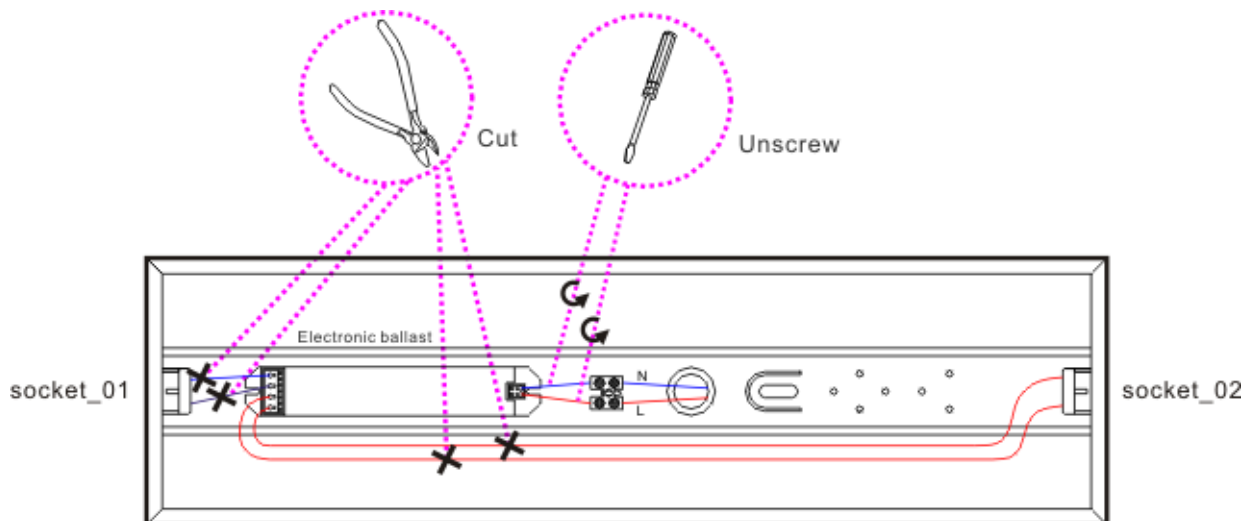

Step 4: Install the MATCHING external power supply shown as Figure 3 below.

The external power supply is sized to match the luminaire and to be installed near the middle of the luminaire by 3M tape and screws provided.

Connect input wires of external power supply to main power outlet.

Connect output wires of external power supply to one of wires of T8 sockets at both sides with wire nuts.

Place the existing cover back to protect the external power supply.

After

Figure 3

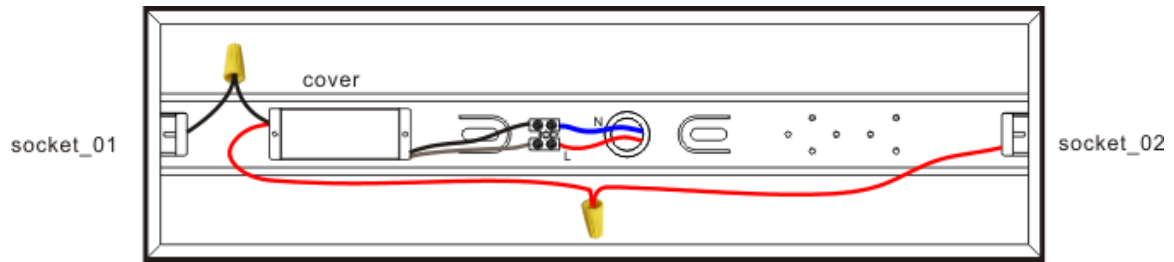

Step 5: Drop iBright™ E25i into fluorescent luminaire. Switch main power on to light up iBright™ E25i.

## ● Retrofit Luminaire with Magnetic Ballast

Before

Figure 4

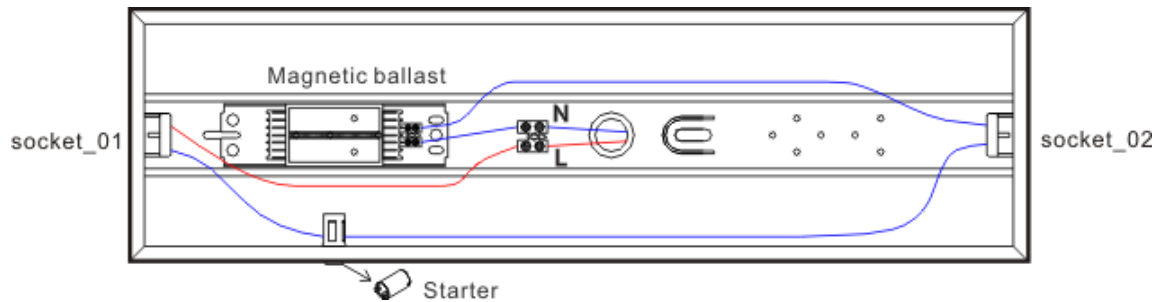

### Installation Steps

Step 1: Turn off main power before installation

For safety, make sure main power source is switched off before attempting to install.

Step 2: Take existing fluorescent light out.

Existing fluorescent light is not needed. You might recycle it as appropriate.

Step 3: Open the ballast cover and disconnect all wires from ballast and starter from T8 sockets shown as Figure 5 below. Remove ballast from the fluorescent luminaire and recycle it as appropriate; keep starter in position; keep one wire of each socket to connect with the external power supply. The other wire shall be cut off immediately near the socket.

Figure 5

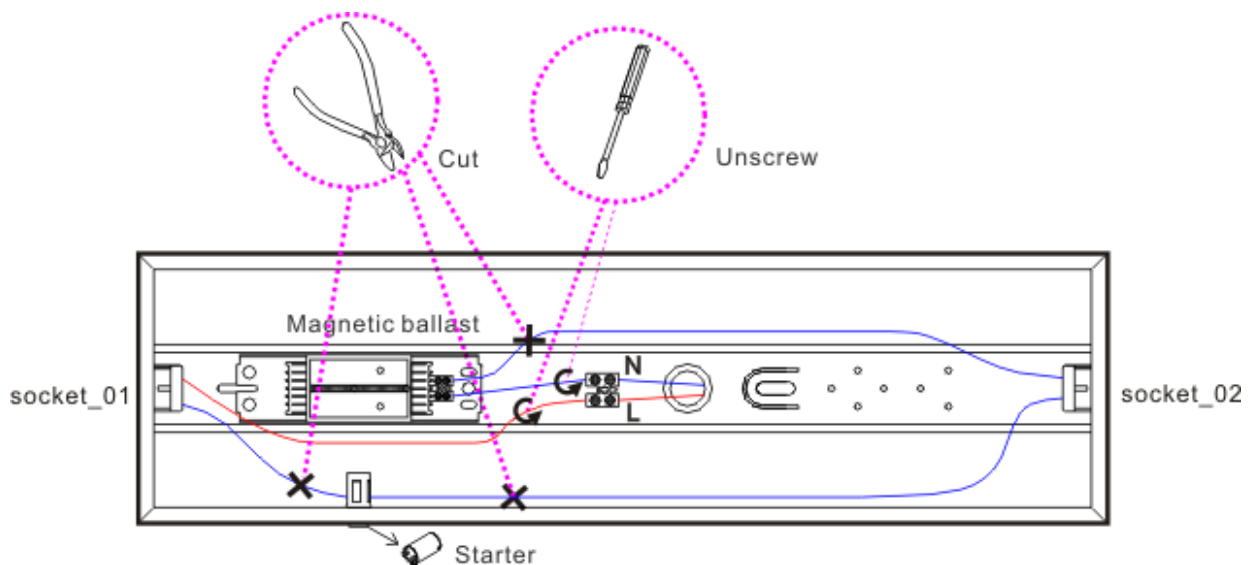

Step 4: Install the MATCHING external power supply shown as Figure 6 below.

The external power supply is sized to match the luminaire and to be installed near the middle of the luminaire by 3M tape and screws provided.

Connect input wires of external power supply to main power outlet.

Connect output wires of external power supply to one of wires of T8 sockets at both sides with wire nuts.

Place the existing cover back to protect the external power supply.

After

Figure 6

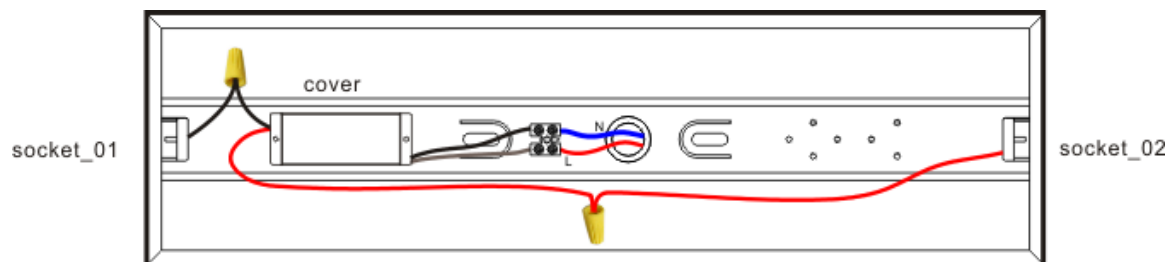

Step 5: Drop iBright™ E25i T8 into fluorescent Luminaire. Switch main power on to light up iBright™ E25i.

#### ATG Electronics® iBright™ E25i T5 LED Tube Specifications

Input Voltage: Max.36VDC (Input Voltage of External Power Supply: 100~277VAC)

Color: White

LED Qty: 30LEDs, 60LEDs, 81LEDs

Power Consumption: 11W ±2W, 20W ±2W, 30W ±2W

Beam Angle: 120 degree

Length: 600mm, 1200mm, 1500mm

Work Environment: Indoor use, dry environments

\* For detailed specifications please refer to the product catalog of iBright™ E25i T5 LED Tube.

628 Zhangyang Road, Suite 1-21B

Shanghai 200122, CHINA

www.atgelectronics.com

E-mail: sales@atgelectronics.com

Phone: +86-21-58350166

Fax: +86-21-58351977

ATG  
Electronics Corp.

Light your world  
Color your life!